

P – PANEL MOUNTING ADAPTER

This panel adapter is a rugged, black, auto extinguishable polycarbonate material. It is mounted with two 6/32 screws. A timer is mounted by clipping to the adapter or panel. Order part number P ADAPT.

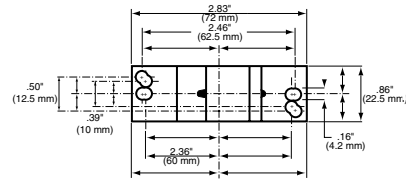
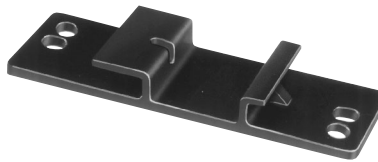

DR – DIN-RAIL

The DR-DIN-Rail material is an extruded aluminum material of the standard configuration, 35mm. Timers and Controls conveniently snap onto the track. Order part number "DR" which is available in 1 meter (39") lengths. Shown with S08, S11 and K11 sockets.

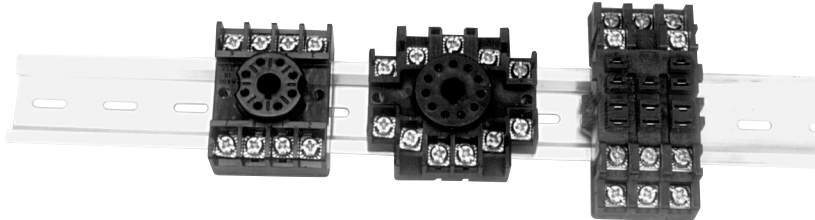

S08, S11 & SCREW TERMINAL SOCKETS

The S08, and S11 are 8 and 11 pin sockets fabricated from a rugged, durable polycarbonate.* The color is grey to match the majority of accessories available. Mounting is with two 6/32 screws .250 or on .30 DIN-Rail, DR. Order part "S08" or "S11."

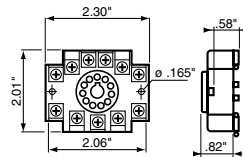

S11

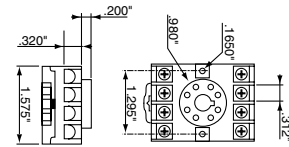

S08

S08-600: 600V, 10A rated 8 pin socket-UL and CSA

S12 & S15 SOLDER TERMINAL SOCKETS

The S12 and S15 are 11 and 8 pin solder terminal sockets fabricated from a rugged, durable polycarbonate. They are black and connections are made by soldering to the tabs or by 3/16" (4.8mm) push-on connectors. Order Part Number "S12" (11 pin) and "S15" (8 pin)

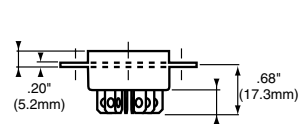
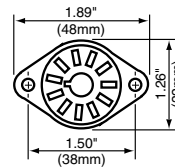

SA8 & SA11 - Back connecting Socket

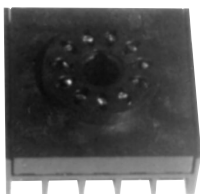

SA11NN

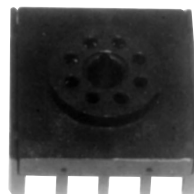
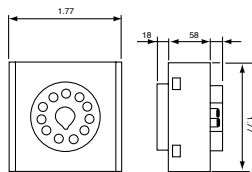

SA8NN

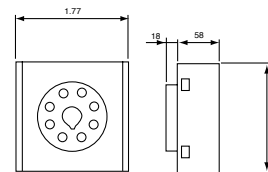

Products and specifications subject to change without notice.

Order/Technical Support – Tel: (800) 677-5311 / FAX: (800) 677-3865 / www.crouzet-usa.com

ACCESSORIES FOR RTM TIMER

SOCKETS PC Board Sockets (mm)

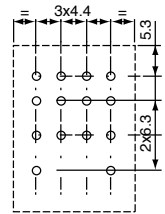
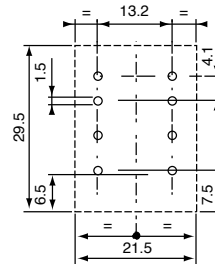
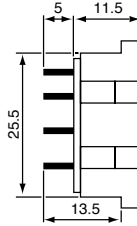
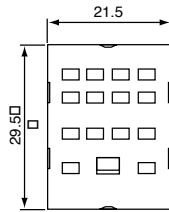
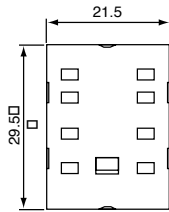

2 Poles
Ref: 26532709

4 Poles
Ref: 26532708

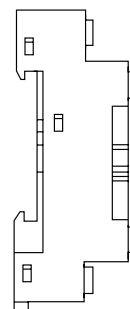
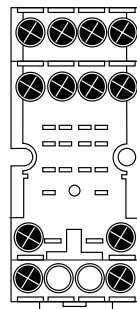
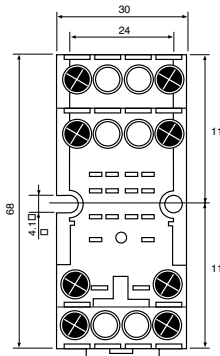

2 Poles
Ref: 26532707

4 Poles
Ref: 26532706

Mounting Clip for DIN-Rail Sockets

Ref: 26532702

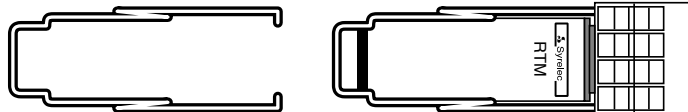

79 238 250 (Part Number)
PANEL MOUNT REMOTE POTENTIOMETER
 470K Ohm ±10% / 0.2 W / linearity ±10%

DIMENSIONS: inches (mm)

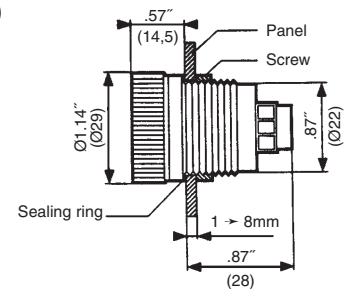

Products and specifications subject to change without notice.

Order/Technical Support – Tel: (800) 677-5311 / FAX: (800) 677-3865 / www.crouzet-usa.com

